



GROUP **ELECTRIC**

Accessories of : Lv & Mv Insulator

Lv & Mv Switchgears & Panels

Central Office add: Unit.20 , No.181 , Golestan 4 , Pasdaran, Tehran , Iran
Factory add : Delgosha St , Main Bld , Abas abad industrial city , Tehran , Iran
Sales Office add: No. 0/14 , 1st floor , bazar sanat complex , Lalehzar South,Tehran ,Iran

Tel : +98-021-22564039

+98-021-33902121

+98-021-33909393

+98-021-33909797

E-mail : Groupelectric2017@gmail.com

INSTAGRAM : [wiand.electric](https://www.instagram.com/wiand.electric)



www.wiand-electric.ir



GROUP ELECTRIC



About Wiand Electric

WIAND ELECTRIC CO Ltd. was incorporated in the year 2005 with the objective of providing quality components for Electrical Control Panels, Distribution Boards and Bus Ducts. The company is operating in IRAN and International Markets and producing wide range of control panel and distribution board components like Stand Off Insulators and Busbar Supports in DMC, SMC and, Brass Terminal Bars and Fans and switch board accessories such as 8PT ,S8,blockset and MNS series and MV Switchgear accessories for Simoprime .Next ,Pix, Unigear series like Bushing , Contacts ,Sockets, Insulation tube,...

From the time of its inception, the company has grown its designing, engineering, tooling, manufacturing and testing capabilities to become the market leaders in the field. At WIAND ELECTRIC we are striving to understand changing customer needs and enrich the quality of their products by simply making the technology readily usable for them. We are proud to have trained professionals, who study, design, develop, enhance, customize and use of various aspects of products manufactured by us. The quality and design has always been the most emphasized area at WIAND ELECTRIC manufacturing facilities. A free technical consultancy service is available for Short Circuit Testing for designing of Power Control Centers with WIAND ELECTRIC products. WIAND ELECTRIC is committed for excellence in quality and our design department provides different application data to customers for IRI testing. There is an on-going philosophy of research and development in providing advance solutions to customer requirement

SM Series



Sm 25-6

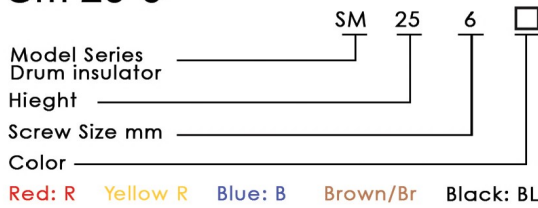

Red: R Yellow R Blue: B Brown/Br Black: BL

● SM-25

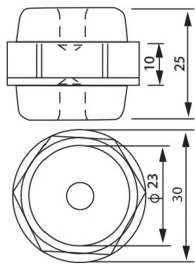

Tensile Strength(LBS)	500
Voltage withstand(Kv)	6
Torgue Strength(FTLBS)	6
Screw(mm)	6
Screw depth (mm)	8



Sm 30-6

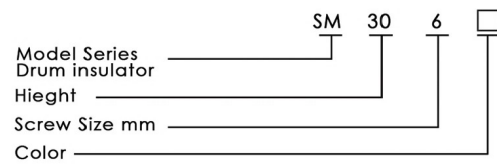

Red: R Yellow R Blue: B Brown/Br Black: BL

● SM-30

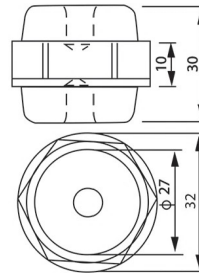

Tensile Strength(LBS)	550
Voltage withstand(Kv)	8
Torgue Strength(FTLBS)	8
Screw(mm)	6
Screw depth (mm)	9



Sm 35-6

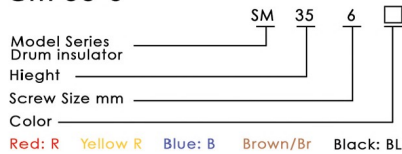

Red: R Yellow R Blue: B Brown/Br Black: BL

● SM-35

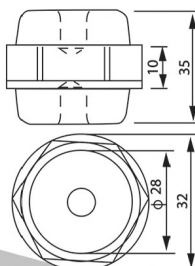

Tensile Strength(LBS)	600
Voltage withstand(Kv)	10
Torgue Strength(FTLBS)	10
Screw(mm)	6
Screw depth (mm)	9



Sm 40-8

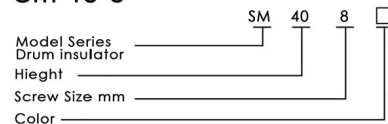

Red: R Yellow R Blue: B Brown/Br Black: BL

● SM-40

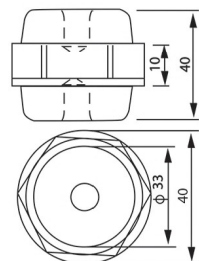

Tensile Strength(LBS)	650
Voltage withstand(Kv)	12
Torgue Strength(FTLBS)	12
Screw(mm)	8
Screw depth (mm)	9



SM Series



Sm 45-8

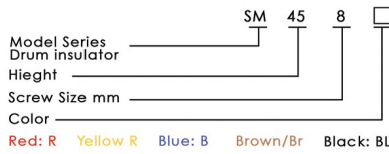

● SM-45

Tensile Strength(LBS)	1000
Voltage withstand(Kv)	14
Torgue Strength(FTLBS)	20
Screw(mm)	8
Screw depth (mm)	9



Sm 50-10

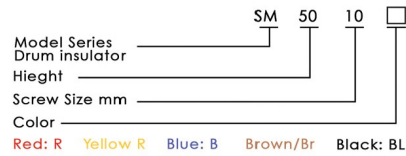

● SM-50

Tensile Strength(LBS)	1000
Voltage withstand(Kv)	15
Torgue Strength(FTLBS)	20
Screw(mm)	10
Screw depth (mm)	18

Sm 60-10

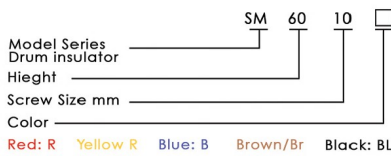

● SM-60

Tensile Strength(LBS)	1200
Voltage withstand(Kv)	20
Torgue Strength(FTLBS)	35
Screw(mm)	10
Screw depth (mm)	18





E & GU Series

VERTICAL INSULATORS



Gu-100

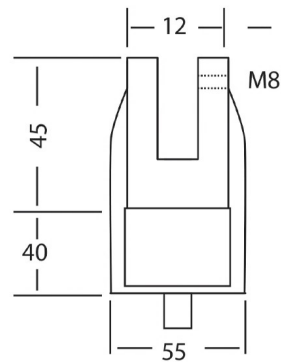
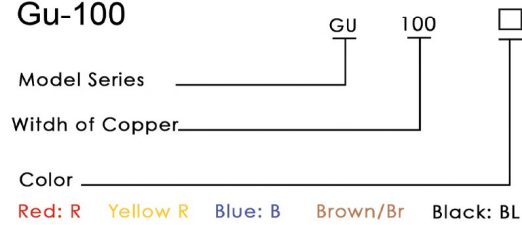

SMU-50

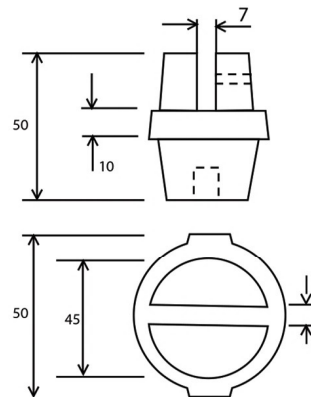
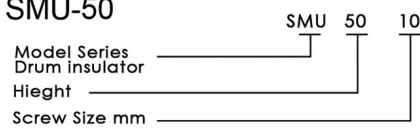



GROUP ELECTRIC

GB Series

VERTICAL INSULATORS



GB-35-6

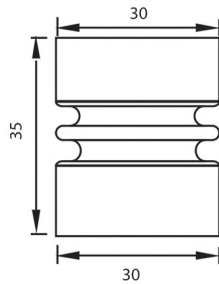
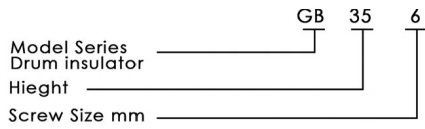

GB-45-8

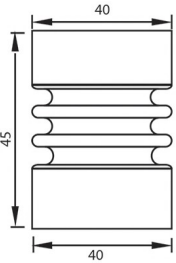
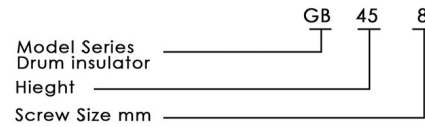

GB-55-10

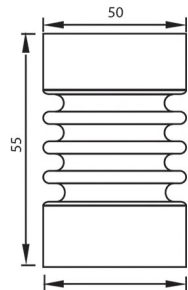
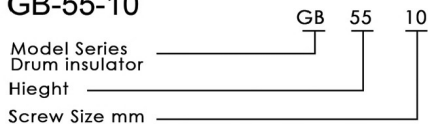

GB-65-10

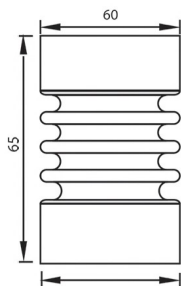
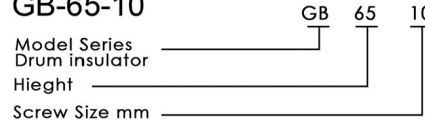



GROUP ELECTRIC

SE4 Series

ACCORDION INSULATORS

SE4-20

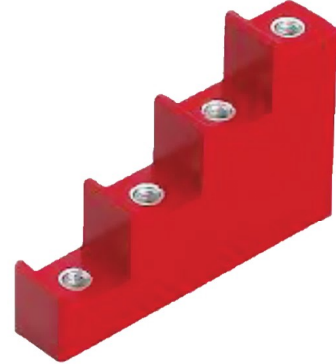
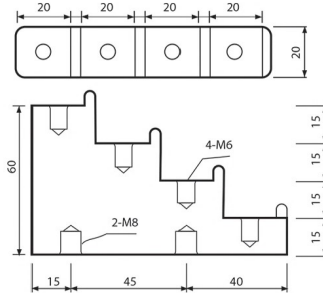
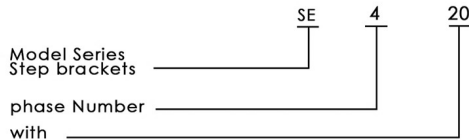

SE4-30

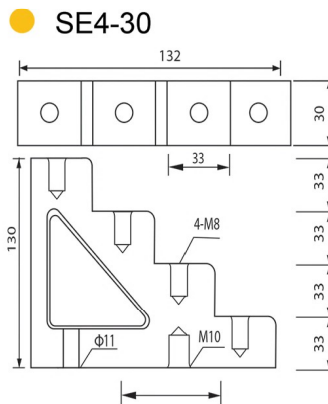
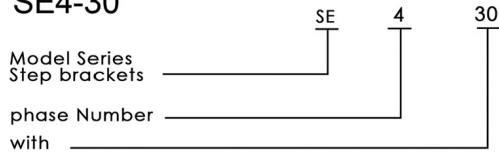

SE4-40

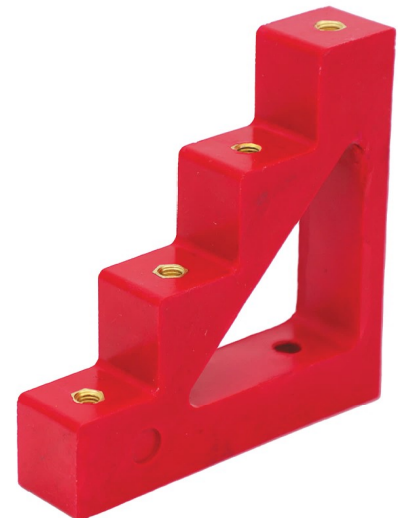
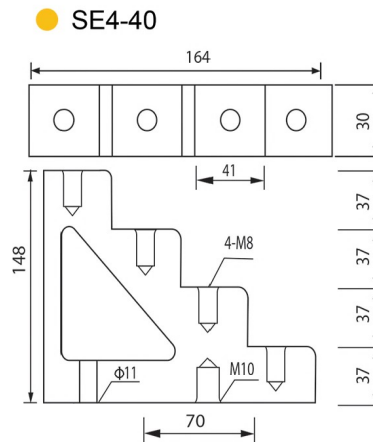
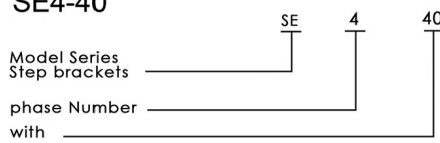

Busbar Series

WIAND



GROUP ELECTRIC

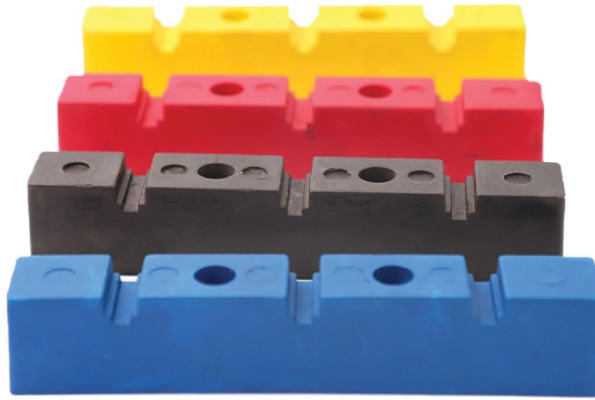

3-P-10

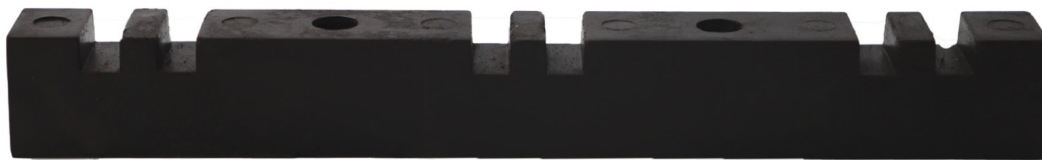
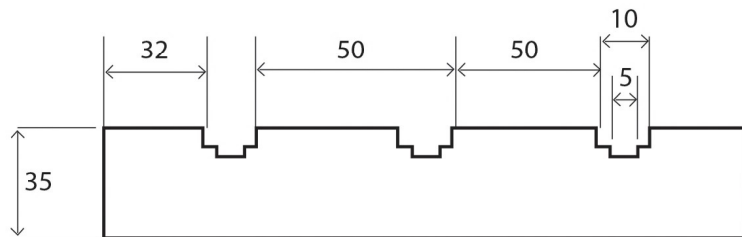
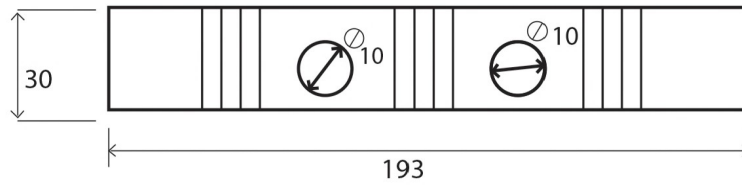

6-P-10

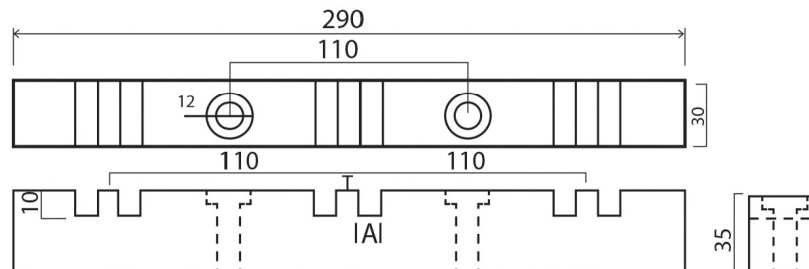



MV INSULATOR

24KV POST

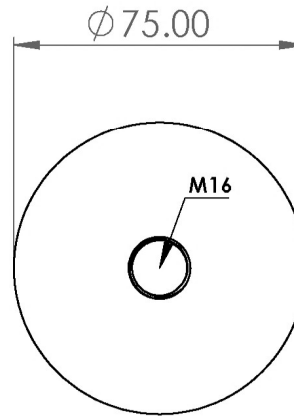
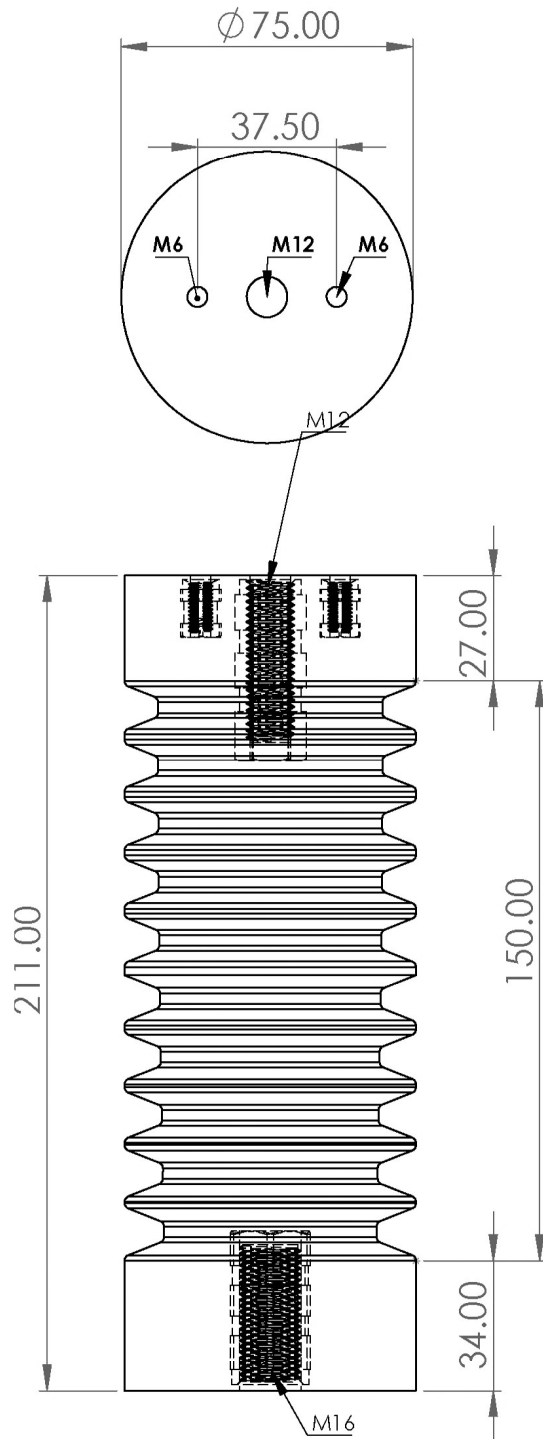



MV INSULATOR

24KV Capacitor

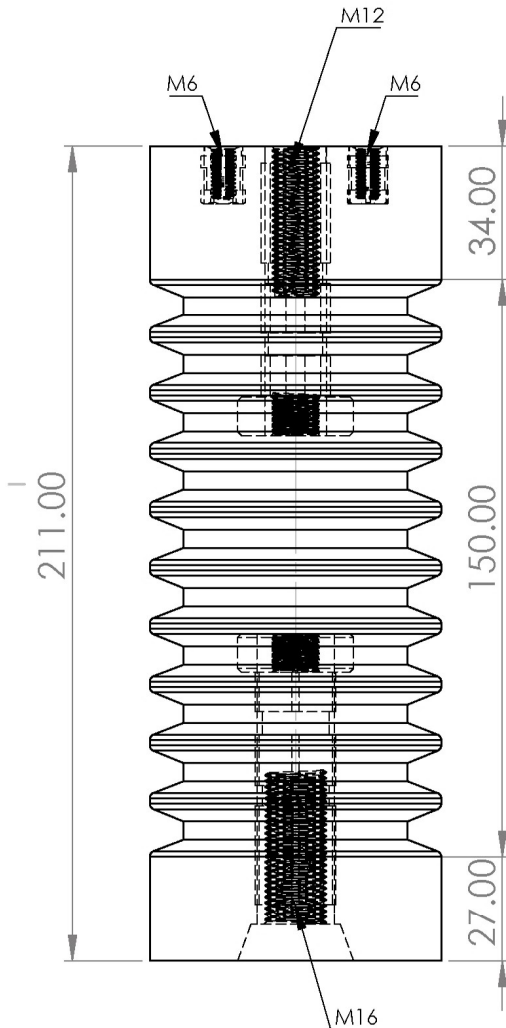
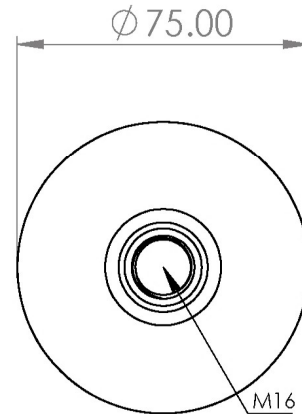
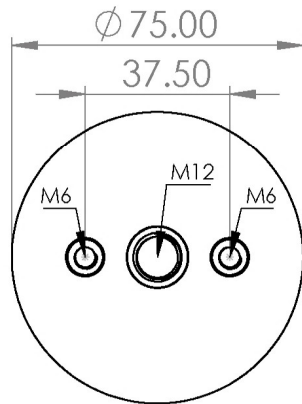



GROUP ELECTRIC

